

## SKLC klauwbeugel

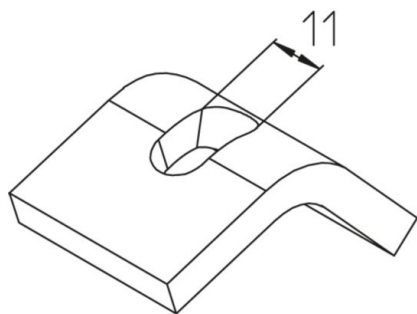

### Thermisch verzinkt volgens BS 729 (DIN EN ISO 1461)

Product	k	P <sub>max</sub>	G
SKLC-HDG	5-25 mm	5 kN	0,16 kg

### Roestvrij staal volgens ASTM 31 Ti / AISI 316 L, BS 320S17 / BS 316S11

Product	k	P <sub>max</sub>	G
SKLC-316	5-25 mm	5 kN	0,16 kg

**k:** klembereik  
**P<sub>max</sub>:** max. belasting  
**G:** gewicht

