

AVLW profielverbinder hoek

hoekverbinder 90Gr 1-1, 1-2, 1-3 of 2-2 gaats

Thermisch verzinkt volgens BS 729 (DIN EN ISO 1461)

| Product | H | B | L | t | G |
|--------------|-------|-------|--------|---------|---------|
| AVLW 1-1-HDG | 40 mm | 42 mm | 58 mm | 6,00 mm | 0,17 kg |
| AVLW 1-2-HDG | 40 mm | 42 mm | 106 mm | 6,00 mm | 0,26 kg |
| AVLW 1-3-HDG | 40 mm | 58 mm | 136 mm | 6,00 mm | 0,36 kg |
| AVLW 2-2-HDG | 40 mm | 89 mm | 106 mm | 6,00 mm | 0,30 kg |

Roestvrij staal volgens ASTM 31 Ti / AISI 316 L, BS 320S17 / BS 316S11

| Product | H | B | L | t | G |
|--------------|-------|-------|--------|---------|---------|
| AVLW 1-1-316 | 40 mm | 42 mm | 58 mm | 6,00 mm | 0,17 kg |
| AVLW 1-2-316 | 40 mm | 42 mm | 106 mm | 6,00 mm | 0,26 kg |
| AVLW 1-3-316 | 40 mm | 58 mm | 136 mm | 6,00 mm | 0,36 kg |
| AVLW 2-2-316 | 40 mm | 89 mm | 106 mm | 6,00 mm | 0,44 kg |

H: hoogte
B: breedte
L: lengte
t: materiaaldikte
G: gewicht



DETAILS / TOEPASSINGEN

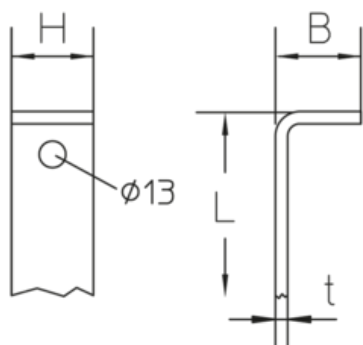

OPTIONELE TOEBEHOREN

AM22, AMF22

