

## USK R122

shuttering, round

Shuttering unit, round, as a deep drawing part made of plastic. For construction of hollow space in screed. Suitable for the installation of a single outlet.

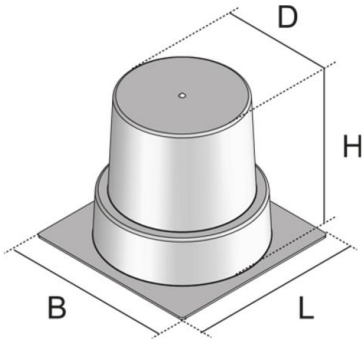

material	polypropylene
type of assembly	Mounting on raw concrete ceiling
application area	screed floors

### Polypropylene

Product	H	B	L	D	color	G
USK-R122	150 mm	180 mm	180 mm	122 mm	black	0,81 kg

**H:** height  
**B:** width  
**L:** length  
**D:** diameter  
**color:**  
**G:** weight

## OPTIONAL ACCESSORIES

BODO T, BODO N4, BODO TL, BODO N, BODO N3, BODO NL

