

UEKDD1-2 V E

stainless steel hinged cover cartridge, single, angular

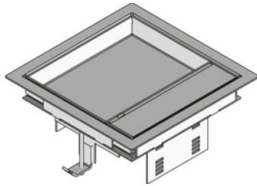

Quadrangular installation unit with high-grade steel carpet protection frame. As cartridge installation frame with lock-in leads for a gradual lowering of the mounting boxes (2 installation devices of 45x45mm) by up to 30 mm, self-closing hinged cartridge cover with floor flush cable outlet and self-locking opening lever, including rubber seal and a universal fastening claw set. For installation into floor boxes, assembly covers and raised or hollow floor openings. Suitable for rooms with dry and damp-cleaned floor covers. Designed for office traffic loads.

Please mind the technical information in chapter planning.



material	cartridge and frame: 2 mm high-grade steel V2A
type of assembly	Assembly in floor box UBDHB, double or hollow floor openings
application area	dry floor cleaning
protection class	in use IP 20 / not in use IP 30
norm	according to DIN EN 50085
permits	according to VDE / TÜV
loading	including inspection stamp Ø 13 mm: 1.5 kN

Stainless steel, according to ASTM 304 / BS 304 S 3

Product	H	H _{min}	B	L	E	T	P _{max}	IP _n	IP _g	G
UEKDD1-2 15-V E	71 mm	80 mm	186 mm	186 mm	165 x 165 mm	12 mm	1,5 kN	IP 30	IP 20	1,26 kg
incl.:										
1x UGD1-2-V 2					rubber seal, angular					
2x UDBS 40-80					special claw					
UEKDD1-2 25-V E	81 mm	90 mm	186 mm	186 mm	165 x 165 mm	22 mm	1,5 kN	IP 30	IP 20	1,41 kg
incl.:										
1x UGD1-2-V 2					rubber seal, angular					
2x UDBS 40-80					special claw					



H: height
H_{min}: Minimum installation height
B: width
L: length
E: fitting dimension
T: depth
P_{max}: Maximum load
IP_n: IP protection level in unused condition
IP_g: IP protection level in used condition
G: weight

DETAILS / APPLICATIONS

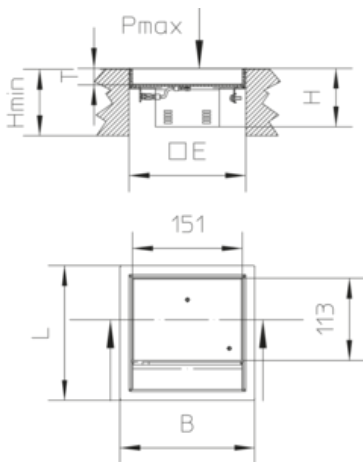

OPTIONAL ACCESSORIES

UDBS 40-80



dry-cleaned

