

## UEKD2 R E

stainless steel hinged cover unit, double, round

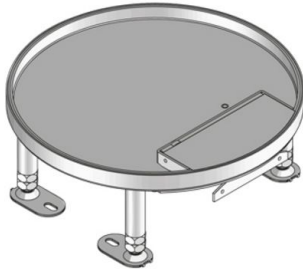

Round cartridge made of stainless steel sheet with hem. As levelling cartridge installation frame with cable outlet cartridge, floor-level cable outlet, self-closing opening lever and rubber seal for the installation into floor boxes, assembly covers and raised or hollow floor openings. To accommodate up to 2 mounting boxes equipped with up to 6 suspension bracket installation devices or 8 installation devices of 45x45mm. Suitable for rooms with dry and damp-cleaned floor covers. Designed for office traffic loads.

Please mind the technical information in chapter planning.



material	Cassette: 2 mm stainless steel V2A, frame: 1.5 mm stainless steel V2A
type of assembly	Assembly in floor box UBDHB, double or hollow floor openings
application area	dry floor cleaning
protection class	in use IP 20 / not in use IP 30
norm	according to DIN EN 50085
permits	according to VDE / TÜV
loading	including inspection stamp Ø 13 / 130 mm: 2 / 3 kN

### Stainless steel, according to ASTM 304 / BS 304 S 3

Product	H	H <sub>min</sub>	N	B	E	T	P <sub>max</sub>	IP <sub>n</sub>	IP <sub>g</sub>	G
UEKD2 15-R E	18 mm	100 mm	55 mm	258 mm	260 mm	12 mm	2 kN	IP 30	IP 20	2,05 kg
incl.:										
1x UGD2-R 10-2					rubber seal, round					
UEKD2 25-R E	28 mm	110 mm	55 mm	258 mm	260 mm	22 mm	2 kN	IP 30	IP 20	2,31 kg
incl.:										
1x UGD2-R 10-2					rubber seal, round					

**H:** height

**H<sub>min</sub>:** Minimum installation height

**N:** levelling range



**B:** width  
**E:** fitting dimension  
**T:** depth  
**P<sub>max</sub>:** Maximum load  
**IP<sub>n</sub>:** IP protection level in unused condition  
**IP<sub>g</sub>:** IP protection level in used condition  
**G:** weight

## DETAILS / APPLICATIONS

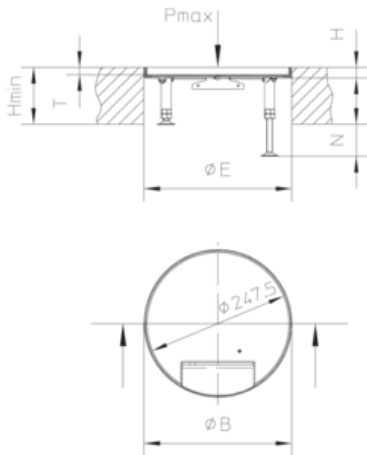

## OPTIONAL ACCESSORIES

UGEAR2, UBDSLFL, UGM SLF



dry-cleaned

