

UEBDSM1-2 V WD

stainless steel heavy-duty tube cover single-outlet cartridge, double, angular

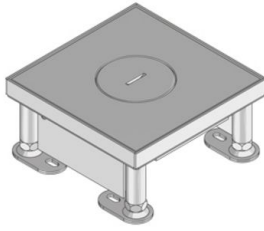

Square single outlet made of flat stainless steel, surface blasted, with welt to accommodate two 45x45 mm module units. As a height-adjustable cartridge installation frame with heavy-duty tube outlet cartridge, screwed-on tube mounting set and rubber seal. For the installation into floor boxes and raised or hollow floor openings. Suitable for rooms with wet-cleaned floor covers. Designed for high traffic loads.

Please mind the technical information in chapter planning.



material	cartridge and frame: 2mm high-grade steel V2A, sub construction: sheet steel galvanized
type of assembly	Assembly on floor box UBDHB / rough concrete ceiling
application area	wet floor cleaning
protection class	in use IP 22 / not in use IP 54
norm	according to DIN EN 50085
permits	according to VDE / TÜV
loading	including inspection stamp Ø 130 mm: 20 kN

Stainless steel, according to ASTM 304 / BS 304 S 3

Product	H	H _{min}	N	B	L	E	P _{max}	IP _n	IP _g	G
UEBDSM1-2 15-V8-WD	19 mm	80 mm	45 mm	160 mm	160 mm	164 x 164 mm	20 kN	IP 54	IP 22	4,39 kg
incl.:										
1x UGD1-2-V 2					rubber seal, angular					
1x UETD-R-WD					tube cover					

H: height
H_{min}: Minimum installation height
N: levelling range
B: width
L: length



E: fitting dimension
P_{max}: Maximum load
IP_n: IP protection level in unused condition
IP_g: IP protection level in used condition
G: weight

DETAILS / APPLICATIONS

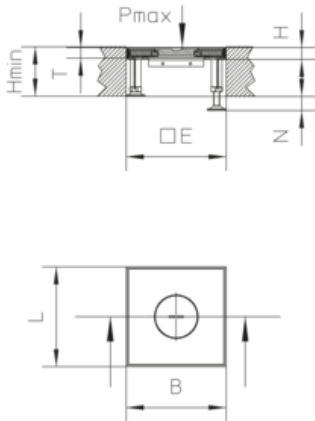

OPTIONAL ACCESSORIES

UGEAV1-2, UGR1-4, UET WD



wet-cleaned

