

UEBDSM V WD

stainless steel heavy-duty tube cover unit, triple, angular

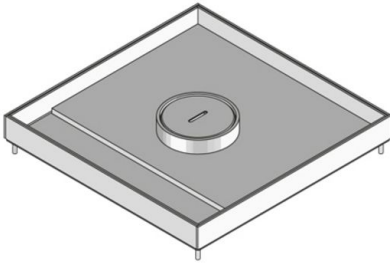

Quadrangular cartridge made of stainless steel sheet with hem. As a cartridge installation frame with heavy-duty tube outlet cartridge, screwed-on aluminium board mounting set, rubber seal and mounting screws. For mounting on top of levelling devices in floor boxes, assembly covers and double or hollow floor openings. To accommodate up to 3 mounting boxes equipped with up to 9 suspension bracket installation devices or 12 installation devices of 45x45 mm. Suitable for rooms with wet-cleaned floor covers. Designed for high traffic loads.

Please mind the technical information in chapter planning.



material	cartridge and frame: 2mm high-grade steel V2A, heavy-duty inlay: hot dip galvanized steel panel, tube mounting set: anodized aluminium
type of assembly	fastening to floor box UBDHB7levelling unit UNE
application area	wet floor cleaning
protection class	in use IP 22 / not in use IP 54
norm	according to DIN EN 50085
permits	according to VDE / TÜV
loading	with inspection stamp Ø 130 mm: 6 00 steel insert = 10 kN / 8 mm steel insert = 20 kN

Aluminium

Product	H	H _{min}	B	L	E	T	P _{max}	IP _n	IP _g	G
UEBDSM 25-V6-WD	29 mm	95 mm	258 mm	258 mm	261 x 261 mm	16 mm	10 kN	IP 54	IP 22	4,7 kg
incl.:										
1x UGD3-V 2					rubber seal, square					
4x UKS M4X16E					Phillips screw					
1x UETD-R-WD					tube cover					
UEBDSM 35-V6-WD	39 mm	105 mm	258 mm	258 mm	261 x 261 mm	26 mm	10 kN	IP 54	IP 22	5,08 kg





Product	H	H _{min}	B	L	E	T	P _{max}	IP _n	IP _g	G
incl.: 1x UGD3-V 2 4x UKS M4X16E 1x UETD-R-WD										
					rubber seal, square Phillips screw tube cover					
UEBDSM 45-V6- WD	49 mm	115 mm	258 mm	258 mm	261 x 261 mm	36 mm	10 kN	IP 54	IP 22	5,4 kg
incl.: 1x UGD3-V 2 4x UKS M4X16E 1x UETD-R-WD										
					rubber seal, square Phillips screw tube cover					
UEBDSM 35-V8- WD	39 mm	105 mm	258 mm	258 mm	261 x 261 mm	24 mm	20 kN	IP 54	IP 22	6,1 kg
incl.: 1x UGD3-V 2 4x UKS M4X16E 1x UETD-R-WD										
					rubber seal, square Phillips screw tube cover					
UEBDSM 45-V8- WD	49 mm	115 mm	258 mm	258 mm	261 x 261 mm	34 mm	20 kN	IP 54	IP 22	6,4 kg
incl.: 1x UGD3-V 2 4x UKS M4X16E 1x UETD-R-WD										
					rubber seal, square Phillips screw tube cover					

H: height
H_{min}: Minimum installation height
B: width
L: length
E: fitting dimension
T: depth
P_{max}: Maximum load
IP_n: IP protection level in unused condition
IP_g: IP protection level in used condition
G: weight

DETAILS / APPLICATIONS



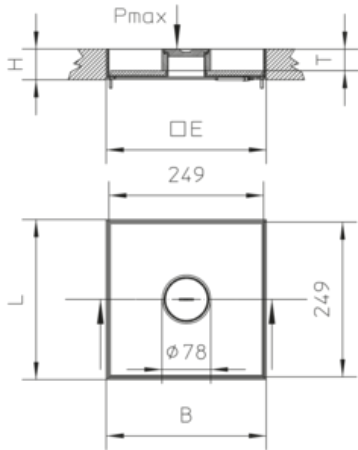

OPTIONAL ACCESSORIES

UET WD, UNE



wet-cleaned

