

## UEBD2 R E

stainless steel dummy cover unit, double, round

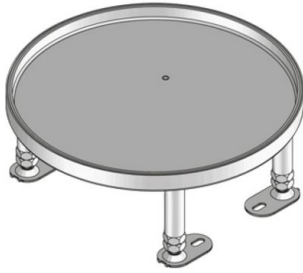

Round cartridge made of stainless steel panel with a hem. As a levelling cartridge installation frame with dummy inlay cartridge and rubber seal for the installation into floor boxes, assembly covers and raised floor or hollow floor openings. Suitable for rooms with wet-cleaned floor covers. Designed for office traffic loads.

Please mind the technical information in chapter planning.



material	Cassette: 2 mm stainless steel V2A, frame: 1.5 mm stainless steel V2A
type of assembly	Assembly in floor box UBDHB, double or hollow floor openings
application area	wet floor cleaning
protection class	not in use IP 54
norm	according to DIN EN 50085
permits	according to VDE / TÜV
loading	including inspection stamp Ø 13 / 130 mm: 2 / 3 kN

### Stainless steel, according to ASTM 304 / BS 304 S 3

Product	H	H <sub>min</sub>	N	B	E	T	P <sub>max</sub>	IP <sub>n</sub>	G
UEBD2 15-R E	18 mm	100 mm	55 mm	258 mm	260 mm	12 mm	2 kN	IP 54	1,82 kg
incl.:									
1x UGEAR-ELS									
1x UGDB15-R300 1.8									
UEBD2 25-R E	28 mm	110 mm	55 mm	258 mm	260 mm	22 mm	2 kN	IP 54	2,04 kg
incl.:									
1x UGEAR-ELS									
1x UGDB15-R300 1.8									

**H:** height

**H<sub>min</sub>:** Minimum installation height

**N:** levelling range

**B:** width



**E:** fitting dimension  
**T:** depth  
**P<sub>max</sub>:** Maximum load  
**IP<sub>n</sub>:** IP protection level in unused condition  
**G:** weight

## DETAILS / APPLICATIONS

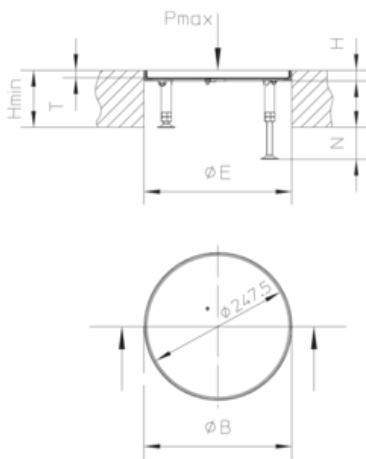

## OPTIONAL ACCESSORIES

UBDSLFL, UGM SLF



wet-cleaned

