

UBEBMAL

T-branch, left

T-branch as an accessory to the screed-flush brush duct.

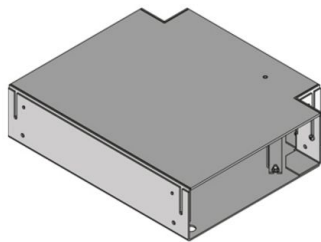

Continuously hot galvanized (Sendzimir process) (DIN EN 10346)

Product	B	L	G
UBEBMAL 85-25S	252 mm	340 mm	5,49 kg

B: width
L: length
G: weight

DETAILS / APPLICATIONS

