

## KDU 57

bracket support, 57x30mm

Ceiling bracket support, U-profile 57x30x2.5 mm, continuously three-way perforated, with welded head plate (material thickness t), certified according to DIN EN 61537.

$F_D/P$ : coefficient for calculation of the dowel load  $F_D$  with effective bracket load P. The permissible loads are achieved by means of a support piece. A support piece must be used from a console length of 400 mm or when mounting in the end area of the ceiling stem. For console lengths < 400 mm without using the support piece, the permissible loads must be reduced by 30 %.

galvanized, according to DIN EN ISO 19598 / DIN EN ISO 2081

Product	L	t	G
KDU 57-02GV	200 mm	5,00 mm	0,55 kg
KDU 57-03GV	300 mm	5,00 mm	0,72 kg
KDU 57-04GV	400 mm	5,00 mm	0,89 kg
KDU 57-05GV	500 mm	5,00 mm	1,06 kg
KDU 57-06GV	600 mm	5,00 mm	1,22 kg
KDU 57-07GV	700 mm	5,00 mm	1,39 kg
KDU 57-08GV	800 mm	5,00 mm	1,57 kg
KDU 57-09GV	900 mm	5,00 mm	1,74 kg
KDU 57-10GV	1000 mm	5,00 mm	1,91 kg
KDU 57-11GV	1100 mm	5,00 mm	2,07 kg
KDU 57-12GV	1200 mm	5,00 mm	2,25 kg
KDU 57-13GV	1300 mm	5,00 mm	2,41 kg
KDU 57-14GV	1400 mm	5,00 mm	2,59 kg
KDU 57-15GV	1500 mm	5,00 mm	2,76 kg

Hot-dip galvanized, according to BS 729 (DIN EN ISO 1461)

Product	L	t	G
KDU 57-02F	200 mm	5,00 mm	0,59 kg





Product	L	t	G
KDU 57-03F	300 mm	5,00 mm	0,77 kg
KDU 57-04F	400 mm	5,00 mm	0,95 kg
KDU 57-05F	500 mm	5,00 mm	1,13 kg
KDU 57-06F	600 mm	5,00 mm	1,31 kg
KDU 57-07F	700 mm	5,00 mm	1,49 kg
KDU 57-08F	800 mm	5,00 mm	1,68 kg
KDU 57-09F	900 mm	5,00 mm	1,86 kg
KDU 57-10F	1000 mm	5,00 mm	2,04 kg
KDU 57-11F	1100 mm	5,00 mm	2,22 kg
KDU 57-12F	1200 mm	5,00 mm	2,40 kg
KDU 57-13F	1300 mm	5,00 mm	2,58 kg
KDU 57-14F	1400 mm	5,00 mm	2,77 kg
KDU 57-15F	1500 mm	5,00 mm	2,95 kg

## Stainless steel, according to ASTM 304 / BS 304 S 3

Product	L	t	G
KDU 57-02E	200 mm	5,00 mm	0,57 kg
KDU 57-03E	300 mm	5,00 mm	0,74 kg
KDU 57-04E	400 mm	5,00 mm	0,91 kg
KDU 57-05E	500 mm	5,00 mm	1,08 kg
KDU 57-06E	600 mm	5,00 mm	1,25 kg
KDU 57-07E	700 mm	5,00 mm	1,42 kg
KDU 57-08E	800 mm	5,00 mm	1,59 kg
KDU 57-09E	900 mm	5,00 mm	1,76 kg
KDU 57-10E	1000 mm	5,00 mm	1,93 kg
KDU 57-11E	1100 mm	5,00 mm	2,10 kg
KDU 57-12E	1200 mm	5,00 mm	2,27 kg
KDU 57-13E	1300 mm	5,00 mm	2,44 kg
KDU 57-14E	1400 mm	5,00 mm	2,61 kg
KDU 57-15E	1500 mm	5,00 mm	2,78 kg



Stainless steel, according to ASTM 31 Ti / AISI 316 L, BS 320S17 / BS 316S11

Product	L	t	G
KDU 57-02E4	200 mm	5,00 mm	0,57 kg
KDU 57-03E4	300 mm	5,00 mm	0,74 kg
KDU 57-04E4	400 mm	5,00 mm	0,91 kg
KDU 57-05E4	500 mm	5,00 mm	1,08 kg
KDU 57-06E4	600 mm	5,00 mm	1,25 kg
KDU 57-07E4	700 mm	5,00 mm	1,42 kg
KDU 57-08E4	800 mm	5,00 mm	1,59 kg
KDU 57-09E4	900 mm	5,00 mm	1,76 kg
KDU 57-10E4	1000 mm	5,00 mm	1,93 kg
KDU 57-11E4	1100 mm	5,00 mm	2,10 kg
KDU 57-12E4	1200 mm	5,00 mm	2,27 kg
KDU 57-13E4	1300 mm	5,00 mm	2,44 kg
KDU 57-14E4	1400 mm	5,00 mm	2,61 kg
KDU 57-15E4	1500 mm	5,00 mm	2,78 kg

**L:** length  
**t:** material thickness  
**G:** weight

## DETAILS / APPLICATIONS

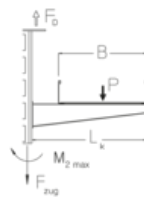
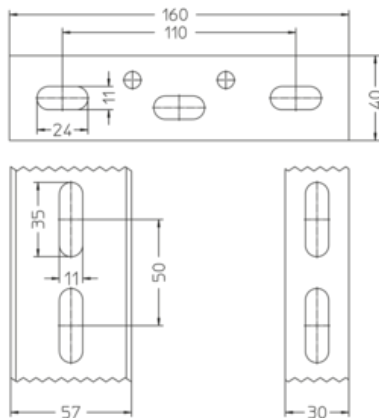

$$M_{2 \max} = 670 \text{ Nm}$$

$$F_{\text{zug}} = 15 \text{ kN}$$

B mm	L <sub>k</sub> mm	P <sub>max</sub> kN	F <sub>D</sub> /P
100	120	6,9	1,4
200	220	4,5	1,9
300	320	3,4	2,3
400	420	2,7	2,8
500	520	2,2	3,2
600	620	1,9	3,7





## OPTIONAL ACCESSORIES

KWF, KW, KWMS, KHU 57, KHUV 57, KHUSS 57, SU 57

