

## BODO N4

single outlet with two floor sockets, wet maintained, round

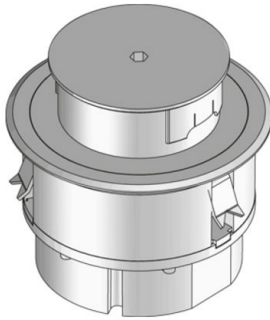

Round single outlet with floor cover protection frame. Including pivotable tube as cable outlet, cover, mounting box with strain-relief, claw set and rubber seal. For installation in floor sockets and raised or hollow space floor openings. Equipped with a double isolated ground receptacle. Suitable for rooms with dry and wet-cleaned floor covers. Designed for high traffic loads.

Please mind the technical information in chapter planning.



|                  |  |
|------------------|--|
| material         | Tube, cover and tube collet: aluminium or stainless steel / frame and mounting box: plastic material |
| type of assembly | Fixing on floor box UBDHB / rough concrete floor and installation in screed or false floor           |
| application area | wet floor cleaning   |
| protection class | in use IP 22 / in use with rubber sleeve UGM1-3 IP 43 / not in use IP 66                             |
| norm             | according to DIN EN 50085  |
| permits          | according to VDE / TÜV   |
| loading          | including inspection stamp Ø 130 mm: 15 kN   |

### Aluminium

| Product         | H      | H <sub>min</sub> | B      | E                            | P <sub>max</sub> | color    | IP <sub>n</sub> | IP <sub>g</sub> | G       |
|-----------------|--------|------------------|--------|------------------------------|------------------|----------|-----------------|-----------------|---------|
| BODO N4         | 122 mm | 87 mm            | 140 mm | 122 mm                       | 15 kN            | aluminum | IP 66           | IP 43           | 0,74 kg |
| incl.:          |        |                  |        |                              |                  |          |                 |                 |         |
| 1x UET80-R-WD   |        |                  |        | 1x tube                      |                  |          |                 |                 |         |
| 1x UETD80-R-WD  |        |                  |        | 1x tube cover                |                  |          |                 |                 |         |
| 1x UST45-W 2    |        |                  |        | 1x shockproof socket, duple  |                  |          |                 |                 |         |
| 1x UARM-4-1 118 |        |                  |        | 1x cover plate for 4x UDAE22 |                  |          |                 |                 |         |
| 1x UG-R         |        |                  |        | 1x mounting box, round       |                  |          |                 |                 |         |
| 2x UGM1-3       |        |                  |        | 1x rubber sleeve             |                  |          |                 |                 |         |
| 1x UWZ-IS 8     |        |                  |        | 1x Allen wrench              |                  |          |                 |                 |         |
| BODO N4-SW      | 122 mm | 87 mm            | 140 mm | 122 mm                       | 15 kN            | black    | IP 66           | IP 43           | 0,74 kg |





| Product   | H      | H <sub>min</sub> | B      | E      | P <sub>max</sub> | color  | IP <sub>n</sub> | IP <sub>g</sub> | G       |
|---|--------|------------------|--------|--------|------------------|--------|-----------------|-----------------|---------|
| incl.:<br>1x UET80-R-WD<br>1x UETD80-R-WD<br>1x UST45-W 2<br>1x UARM-4-1 118<br>1x UG-R<br>2x UGM1-3<br>1x UWZ-IS 8 |        |                  |        |        |                  |        |                 |                 |         |
|   |        |                  |        |        |                  |        |                 |                 |         |
| BODO N4-CR  | 122 mm | 87 mm            | 140 mm | 122 mm | 15 kN            | chrome | IP 66           | IP 43           | 0,74 kg |

|   |  |  |  |  |  |  |  |  |  |
|---|--|--|--|--|--|--|--|--|--|
| incl.:<br>1x UET80-R-WD<br>1x UETD80-R-WD<br>1x UST45-W 2<br>1x UARM-4-1 118<br>1x UG-R<br>2x UGM1-3<br>1x UWZ-IS 8 |  |  |  |  |  |  |  |  |  |
|   |  |  |  |  |  |  |  |  |  |

**Brass**

| Product   | H      | H <sub>min</sub> | B      | E      | P <sub>max</sub> | color        | IP <sub>n</sub> | IP <sub>g</sub> | G       |
|---|--------|------------------|--------|--------|------------------|--------------|-----------------|-----------------|---------|
| BODO N4-MMS   | 122 mm | 87 mm            | 140 mm | 122 mm | 15 kN            | brass, solid | IP 66           | IP 43           | 1,51 kg |
| incl.:<br>1x UET80-R-WD<br>1x UETD80-R-WD<br>1x UST45-W 2<br>1x UARM-4-1 118<br>1x UG-R<br>2x UGM1-3<br>1x UWZ-IS 8 |        |                  |        |        |                  |              |                 |                 |         |
|   |        |                  |        |        |                  |              |                 |                 |         |

**Stainless steel, according to ASTM 304 / BS 304 S 3**

| Product   | H      | H <sub>min</sub> | B      | E      | P <sub>max</sub> | color                  | IP <sub>n</sub> | IP <sub>g</sub> | G       |
|-----------|--------|------------------|--------|--------|------------------|------------------------|-----------------|-----------------|---------|
| BODO N4-E | 122 mm | 87 mm            | 140 mm | 122 mm | 15 kN            | Stainless steel, solid | IP 66           | IP 43           | 1,47 kg |



| Product         | H | H <sub>min</sub> | B | E | P <sub>max</sub> | color                     | IP <sub>n</sub> | IP <sub>g</sub> | G |
|-----------------|---|------------------|---|---|------------------|---------------------------|-----------------|-----------------|---|
| incl.:          |   |                  |   |   |                  |                           |                 |                 |   |
| 1x UET80-R-WD   |   |                  |   |   |                  | tube                      |                 |                 |   |
| 1x UETD80-R-WD  |   |                  |   |   |                  | tube cover                |                 |                 |   |
| 1x UST45-W 2    |   |                  |   |   |                  | shockproof socket, duple  |                 |                 |   |
| 1x UARM-4-1 118 |   |                  |   |   |                  | cover plate for 4x UDAE22 |                 |                 |   |
| 1x UG-R         |   |                  |   |   |                  | mounting box, round       |                 |                 |   |
| 2x UGM1-3       |   |                  |   |   |                  | rubber sleeve             |                 |                 |   |
| 1x UWZ-IS 8     |   |                  |   |   |                  | Allen wrench              |                 |                 |   |

**H:** height

**H<sub>min</sub>:** Minimum installation height

**B:** width

**E:** fitting dimension

**P<sub>max</sub>:** Maximum load

**color:**

**IP<sub>n</sub>:** IP protection level in unused condition

**IP<sub>g</sub>:** IP protection level in used condition

**G:** weight

## DETAILS / APPLICATIONS

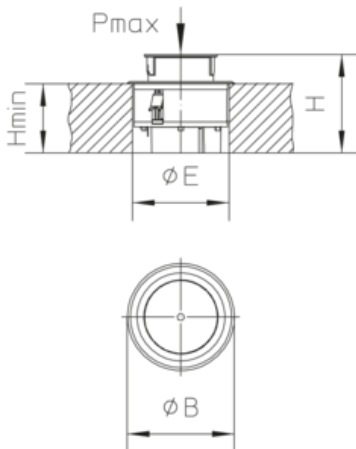

## OPTIONAL ACCESSORIES

USK R122, UBDHB 122R





wet-cleaned



Electrical and electronic equipment must not be disposed off via the household waste.

