

AVLW

rail connector, angular

corner connector 90 ° 1-1, 1-2, 1-3 or 2-2 hole

Hot-dip galvanized, according to BS 729 (DIN EN ISO 1461)

Product	H	B	L	t	G
AVLW 1-1-HDG	40 mm	42 mm	58 mm	6,00 mm	0,17 kg
AVLW 1-2-HDG	40 mm	42 mm	106 mm	6,00 mm	0,26 kg
AVLW 1-3-HDG	40 mm	58 mm	136 mm	6,00 mm	0,36 kg
AVLW 2-2-HDG	40 mm	89 mm	106 mm	6,00 mm	0,30 kg

Stainless steel, according to ASTM 31 Ti / AISI 316 L, BS 320S17 / BS 316S11

Product	H	B	L	t	G
AVLW 1-1-316	40 mm	42 mm	58 mm	6,00 mm	0,17 kg
AVLW 1-2-316	40 mm	42 mm	106 mm	6,00 mm	0,26 kg
AVLW 1-3-316	40 mm	58 mm	136 mm	6,00 mm	0,36 kg
AVLW 2-2-316	40 mm	89 mm	106 mm	6,00 mm	0,44 kg

H: height
B: width
L: length
t: material thickness
G: weight



DETAILS / APPLICATIONS

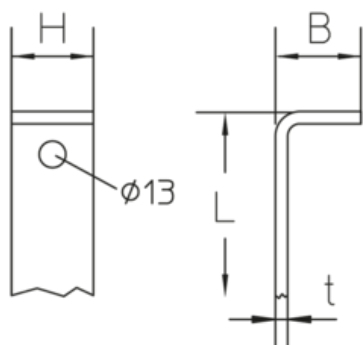

OPTIONAL ACCESSORIES

AM22, AMF22

